

Countershaft Bearing

Special Tool(s)

| | |
|---|---|
|  <p>ST1895-A</p> | <p>Remover, Drive Pinion Bearing Cone 205-D002 (D79L-4621-A) or equivalent</p> |
|---|---|

Transmission Internal Components — Countershaft Disassembled View

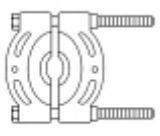
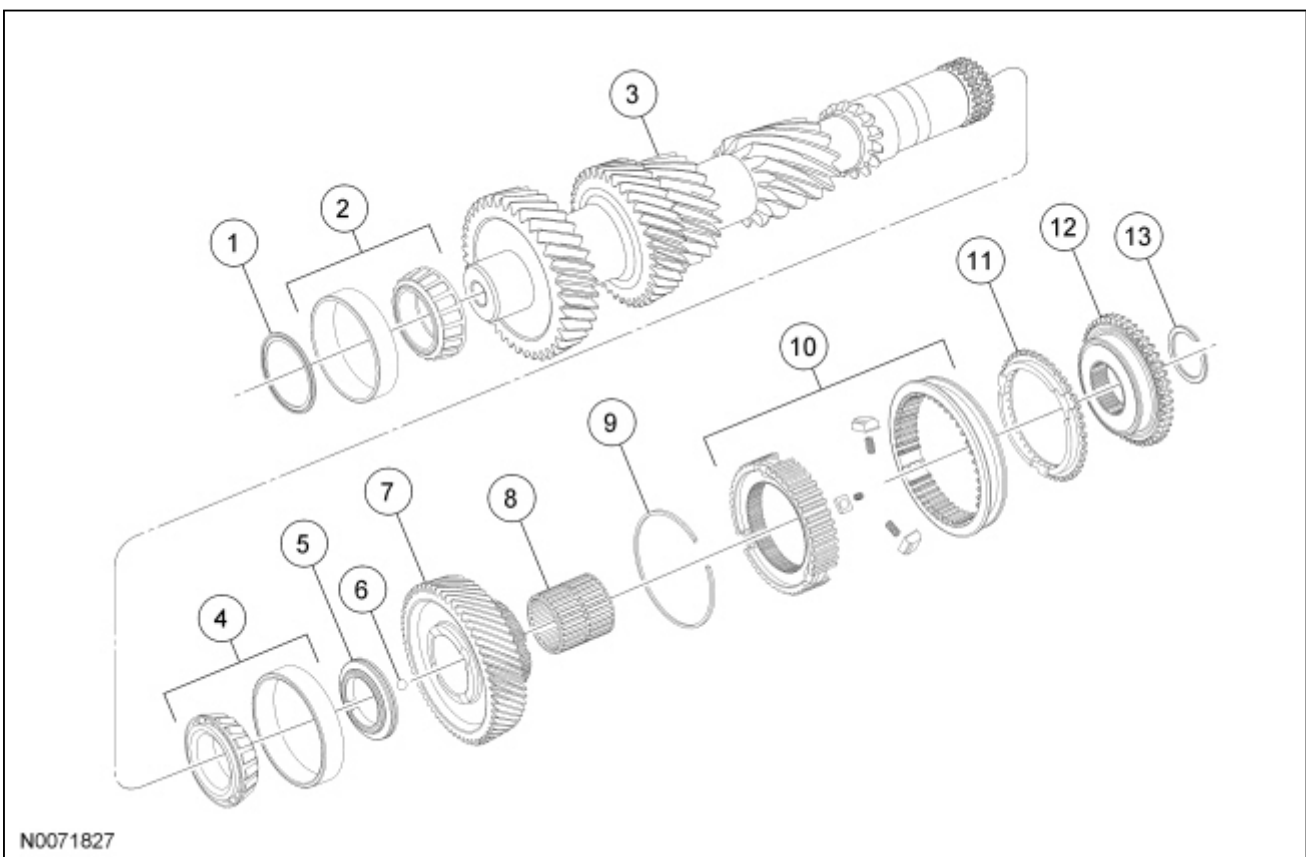

| Item | Part Number | Description |
|------|-------------|--|
| 1 | 7L172 | Shim |
| 2 | 7025 | Countershaft front bearing and cup |
| 3 | 7113 | Countershaft |
| 4 | 7025 | Countershaft rear bearing and cup |
| 5 | 7L271 | Thrust bearing (part of spring kit) |
| 6 | 7L271 | Check ball (part of spring kit) |
| 7 | 7124 | Countershaft 5th gear (part of 5th gear and synchronizer assembly) |
| 8 | 7025 | Countershaft 5th gear needle bearing |
| 9 | — | Retaining ring (part of 5th gear synchronizer assembly) |

| | | |
|----|-------|---|
| 10 | 7124 | Countershaft 5th gear and synchronizer assembly |
| 11 | 7107 | 5th gear synchronizer blocking ring |
| 12 | 7124 | 5th gear clutch cone |
| 13 | 7L271 | Retaining ring (part of spring kit) |

Disassembly and Assembly

1. Using a suitable tool, cut the outer cage, then remove the outer cage and rollers.

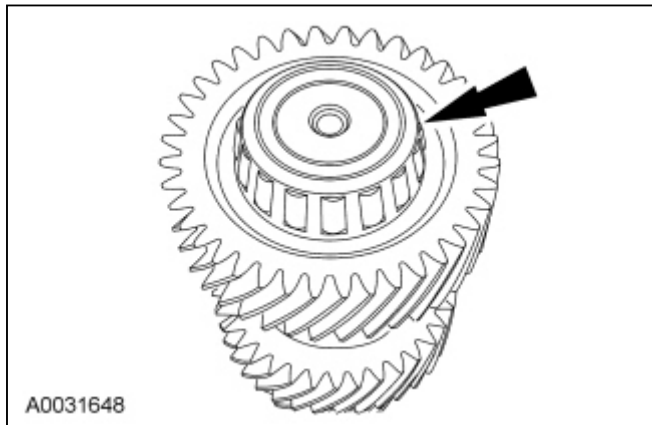

2. Using the Drive Pinion Bearing Cone Remover and a press, remove the inner bearing.

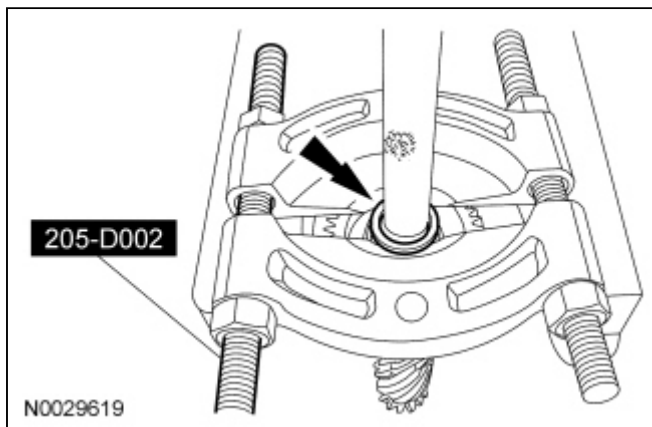

3. Using a suitable tool, install the new countershaft bearing.

